

GO

GRAND

GRAND HYATT SHANGHAI

Jin Mao Tower, 88 Century Avenue
Pudong, Shanghai 200121, China

T 86 21 8024 1234

F 86 21 5049 1111

shanghai.grand.hyatt.com

Hyatt, Grand Hyatt, and related marks are trademarks of Hyatt Corporation or its affiliates.
© 2024 Hyatt Corporation. All rights reserved.

GRAND HYATT SHANGHAI

GRAND | HYATT
君悦酒店



PATIO

SHANGHAI

GO

[WELCOME]

Welcome to vibrant Shanghai, a major business and financial hub in China. This modern and culturally rich metropolis has a distinctive style known as "Shanghai Culture."

The Grand Hyatt Shanghai continues the tradition of the Hyatt Hotel Group collaborating with landmark buildings, making the magnificent Jinmao Tower a home away from home for countless travellers. Standing tall at the heart of Shanghai, the 88-story pyramid-shaped building boasts stunning views of the Bund and the city's vibrant skyline. The Grand Hyatt Shanghai Hotel blends traditional elegance with modern sophistication, providing comfortable accommodations and unique dining and entertainment experiences for distinguished guests.

GRAND

COMFORTABLE GUEST ROOMS

PRESIDENTIAL SUITE



PRESIDENTIAL SUITE



CLUB LOUNGE



GRAND RIVERVIEW ROOM

G

GUEST ROOM

There are 548 guest rooms and suites located on floors 58 to 85 of Jinmao Tower. The rooms are elegant and spacious, blending Western Art Deco style with traditional Chinese classical culture, and equipped with modern conveniences to provide guests with a comfortable and convenient stay.

SERVICES AND FACILITIES

- Wireless high-speed internet access throughout the hotel
- Concierge service
- In-room dining service
- Business center
- Foreign exchange service
- Laundry service

• GRAND CLUB™

Club Lounge provides a luxurious and exclusive atmosphere and personalized services for travelers. Grand Club Lounge is the core of the 79 Club rooms and 43 Club suites, with double-story floor-to-ceiling glass windows offering unobstructed views of the Bund. Club Lounge provides European-style breakfast, all-day soft drinks, afternoon tea, evening cocktails, delicate desserts, and other amenities; guests staying in Guest Club rooms can enjoy private check-in and check-out, free pressing of one suit or garment, and free use of the business center or 83rd floor meeting room services for one hour per day.

GUEST ROOMS:

- 188 Grand Rooms
- 237 Grand Riverview and CityView Rooms
- 30 Club Rooms
- 49 Club RiverView Rooms
- 33 Grand Suites
- 8 Diplomat Suites
- 2 Presidential Suites
- 1 Chairman Suite

Guests can enjoy the following in each room:

- Wired/wireless broadband internet access
- Floor-to-ceiling windows
- Views of the Huangpu River and the city.

GRAND



EVENT | CONFERENCE AND
EVENT VENUES

AQUARIUS



CRYSTAL BALLROOM



GRAND BALLROOM

G O

EVENT | CONFERENCE AND EVENT VENUES

The Grand Hyatt Shanghai offers flexible venue options for your events. From high-caliber meetings to private events or weddings, from board meetings to large banquets, our professional banquet coordinators can meet every detail of your requirements. With a full range of banquet and meeting facilities, it will be the ideal choice for you to hold successful conferences and banquets.

EVENT VENUES

Two magnificent grand ballrooms and 11 well-equipped, highly flexible multi-function rooms can accommodate various-sized banquets and meetings, and can present diverse table settings and configurations according to your requirements. All meeting rooms and banquet halls are equipped with modern technology equipment and exquisite amenities to ensure that every detail of your meetings and exhibitions is executed comprehensively, effortlessly, and accurately.

- A grand ballroom with a total area of 1,585 square meters can accommodate up to 2000 people.
- 11 flexible medium-sized meeting venues.
- A separate conference room in the Business Center can accommodate about 12 people.
- The newly unveiled Water Bottle Hall, with a total area of 368 square meters, can accommodate up to 270 people.

• *Grand Ballroom*

With a total area of 920 square meters, the grand ballroom can accommodate up to 792 people for a banquet or up to 1,200 people for a cocktail party and can provide different table settings and configurations to accommodate banquets and meetings of various sizes.

• *Crystal Ballroom*

Crystal Ballroom with an area of up to 665 square meters, can be divided into three separate meeting rooms independently. Crystal Ballroom can accommodate up to 480 guests for a banquet or 800 guests for a cocktail reception. It can be set up in theater or classroom style for meetings, and the magnificent crystal chandeliers add an extra touch of elegance to the venue.

• *Aquarius*

The newly launched Aquarius Room features two multi-functional halls with a total area of approximately 368 square meters, accommodating up to 270 guests at the same time. It is equipped with brand-new audio facilities and LED electronic screens, making it an ideal venue for cocktail parties, meetings, or banquets. The superior height creates a feeling of being in the clouds, while the soaring floor-to-ceiling windows offer a panoramic view, allowing guests to enjoy the splendid view of Shanghai from the banquet hall.

G R A N D

厅名 ROOM NAME	规格 ROOM DIMENSIONS L X W X H	会议室面积 SQ. FT. METERS	 宴会式 BANQUET	 酒会式 RECEPTION	 剧院式 THEATER	 课桌式 CLASSROOM	 董事会 BOARDROOM	 U-形 U-SHAPE
酒店裙房二层 / Podium Level 2								
嘉宾厅 CRYSTAL BALLROOM	103.4' X 70.2' X 17.7' 31.5 X 21.4 X 5.4	7159 665	480	800	720	430	156	126
嘉宾厅 I CRYSTAL BALLROOM I	32.8' X 70.2' X 17.7' 10 X 21.4 X 5.4	2,314 215	144	236	215	135	84	72
嘉宾厅 II CRYSTAL BALLROOM II	37.8' X 70.2' X 17.7' 11.5 X 21.4 X 5.4	2,531 235	204	258	265	145	84	72
嘉宾厅 III CRYSTAL BALLROOM III	32.8' X 70.2' X 17.7' 10 X 21.4 X 5.4	2,314 215	144	236	215	135	84	72
嘉宾厅 I+II CRYSTAL BALLROOM I+II	70.6' X 70.2' X 17.7' 21.5 X 21.4 X 5.4	4,845 450	360	495	500	300	120	90
嘉宾厅 II+III CRYSTAL BALLROOM II+III	70.6' X 70.2' X 17.7' 21.5 X 21.4 X 5.4	4845 450	360	495	500	300	120	90
天秤厅 LIBRA	26.2' X 19.7' X 8.2' 8 X 6 X 2.5	484 45	24	35	40	20	16	12
金牛厅 TAURUS	26.2' X 23' X 8.2' 8 X 7 X 2.5	592 55	24	45	40	24	24	15
双子厅 GEMINI	26.2' X 26.2' X 8.2' 8 X 8 X 2.5	700 65	24	50	40	20	24	15
董事会议室 BOARDROOM	19.7' X 31.5' X 8.2' 6 X 9.6 X 2.5	538 50	-	-	-	-	12	-

酒店裙房二层 / Podium Level 2

宴会厅 GRAND BALLROOM	147.6' X 72' X 17.7' 45 X 22 X 5.4	10,628 920	792	1,200	1,050	640	200	175
宴会厅 I GRAND BALLROOM I	52.5' X 72' X 17.7' 16 X 22 X 5.4	3,523 305	264	335	360	180	100	75
宴会厅 II GRAND BALLROOM II	52.5' X 72' X 17.7' 16 X 22 X 5.4	4,043 350	288	385	420	240	100	80
宴会厅 III GRAND BALLROOM III	42.6' X 72' X 17.7' 13 X 22 X 5.4	3,062 265	204	291	320	120	85	70
宴会厅 I+II GRAND BALLROOM I+II	105' X 72' X 17.7' 32 X 22 X 5.4	7,566 655	552	720	780	468	150	120
宴会厅 II+III GRAND BALLROOM II+III	95.2' X 72' X 17.7' 29 X 22 X 5.4	7,105 615	516	676	740	392	150	120
宴宾厅 I DRAWING ROOM I	36' X 19.7' X 8.2' 11 X 6 X 2.5	592 55	15	45	-	-	-	-
宴宾厅 II DRAWING ROOM II	52.5' X 16.4' X 10.5' 16 X 5 X 3.2	861 80	36	88	80	42	42	36
双鱼厅 PISCES	26.3' X 26.3' X 8.2' 8 X 8 X 2.5	692 62	24	68	50	15	24	20
白羊厅 ARIES	26.3' X 26.3' X 8.2' 8 X 8 X 2.5	692 62	24	68	50	15	24	20

酒店裙房二层
Podium Level 2

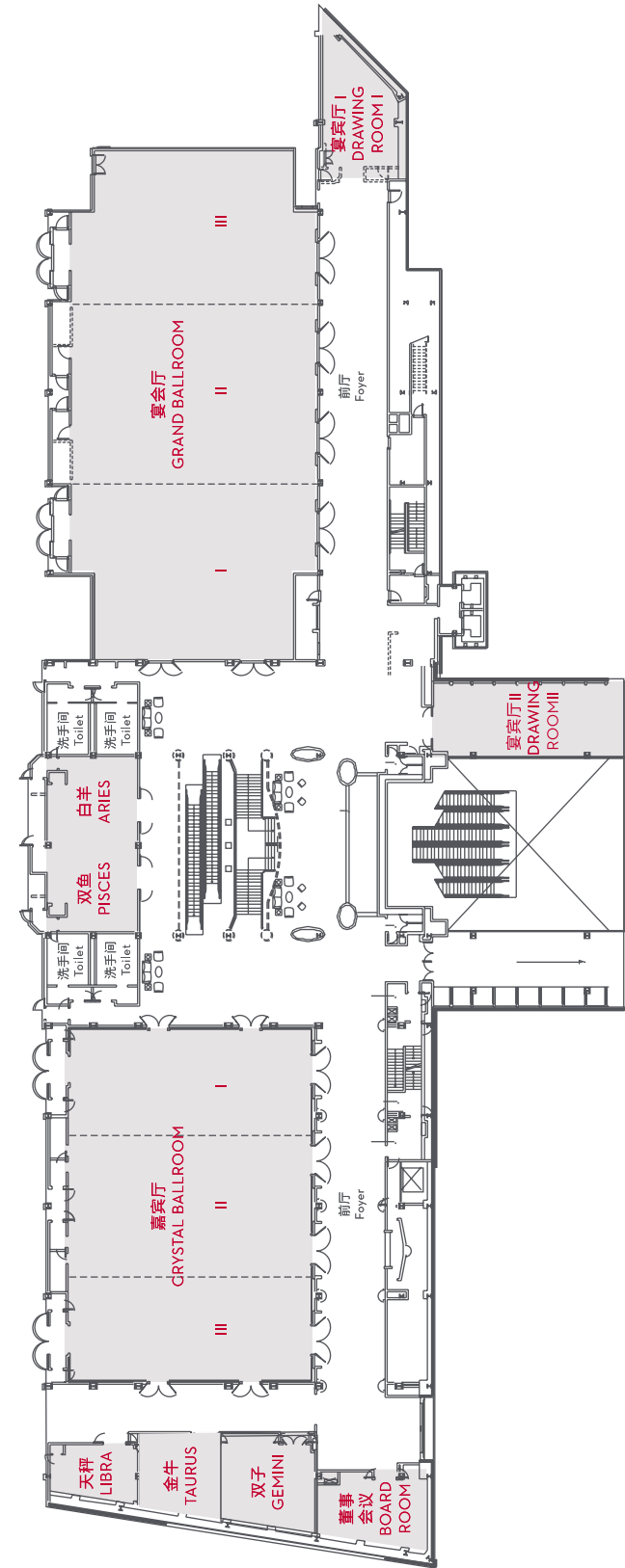



CRYSTAL BALLROOM



GRAND BALLROOM

GO

BANQUETS AND WEDDINGS

Our professional banquet service staff and culinary team will design delicious menus tailored to your event. We will use fresh ingredients to create scrumptious dishes that are both visually and tastefully appealing. Whether you are hosting a small themed gathering, a grand banquet, or a product launch, our banquet team will provide attentive and personalized service. Combined with the venue's state-of-the-art facilities, we will ensure that you have a memorable event.

WEDDINGS

Celebrate one of the most important days of your life in the grandeur and elegance of The Grand Hyatt Shanghai. No matter whether it's a lavish wedding banquet held in the grand ballroom, a cocktail party with dim lighting in the Guest Hall, or a romantic wedding ceremony presented in the Cloud Space, The Grand Hyatt Shanghai will fulfill the wishes of the newlyweds. Professional wedding experts at the hotel can take care of every need of the couple and create a unique wedding experience for them.

THEME PARTIES

The vibrant nightlife of Shanghai comes alive in our themed parties, where the Grand Ballroom serves as a vivid representation of the vitality of old and new Shanghai. We meticulously design each program for every event to reflect and enhance the theme of the event. The exceptional service at The Grand Hyatt Shanghai is designed to make your event even more memorable.

GRAND



GO

OUTSIDE CATERING

The Grand Hyatt Shanghai has a professional outdoor catering team that provides creative, high-quality catering services and personalized services.



OUTSIDE CATERING SERVICE

Whether it's a yacht dinner or an event in Shanghai, our professional banquet coordinators will work closely with organizers to ensure the success of any event. Our services include venue selection, theme design, delivery, table setting, and full-service throughout the event. For any requirement, our customized solutions can guarantee the success of the event.



GRAND

F&B AND ENTERTAINMENT





G

FOOD & BEVERAGE

The Grand Hyatt Shanghai offers a variety of catering options to suit your needs, including Western, Chinese, and Halal cuisine. Experience the finest dining at Grand Hyatt Shanghai, where 8 diverse restaurants and bars in the bustling city of Shanghai will take you on a gastro-nomic journey to tantalize your taste buds and provide you with a delightful experience in a stylish and relaxed atmosphere.

INDULGE IN EXQUISITE DINING EXPERIENCES AND ENJOY THE CITY'S SPLENDID VIEWS.

• Cloud 9

Located at the top of the 87th floor tower, the Western-style restaurant and sky lounge offers panoramic views of the city and was once named by Newsweek as "one of the world's best party venues."

• Club Jin Mao

Located on the 86th floor, Club Jin Mao is a refined Shanghai-style cuisine restaurant with a superior height that offers panoramic views of the city, making it an ideal choice for business banquets or family gatherings.

• On 56

On 56 offers a unique dining atmosphere with modern urban art decor. Guests can enjoy buffet meals for breakfast, lunch, and dinner, as well as fresh European and Shanghai cuisine from the à la carte menu. The floor-to-ceiling windows offer diners a 270-degree view of the city.

• Kobachi

Kobachi Japanese restaurant can prepare classic and traditional sushi, sashimi, and yakitori for guests, accompanied by sake to savor the traditional and classic flavors of Japanese cuisine.

• Canton

Exquisite Cantonese cuisine is presented by skilled chefs, shining alongside the magnificent skyline, making it an ideal venue for entertaining guests.

• Patio

beneath the breathtaking atrium spiralling 33 floors up to the building's crown; Patio makes for a spectacular setting for afternoon tea or drinks. Located on the 56th floor, Patio at Grand Hyatt Shanghai owes its soothing atmosphere to the warm glow of polished quartz columns and the dazzling display of high-speed lifts in their glass enclosures.

• Impression Art Gallery Restaurant

The newly opened 53rd-floor Impression Art Gallery Restaurant at The Grand Hyatt Shanghai offers guests a multi-sensory journey to showcase the charm of art and cuisine. The restaurant's interior decoration is inspired by "Impression of the Wilderness," integrating nature and art together. Guests can enjoy the flowing light in the high-altitude art space.

• Pastry Boutique

Pastry Boutique offers a variety of handmade chocolates, cakes, and desserts, making it the perfect gift for friends and business partners.





FITNESS CENTER

CLUB OASIS - FITNESS CENTER



GO

RECREATIONAL FACILITIES

Guests can relax after a busy day by visiting the Oasis Fitness Center, located on the 57th floor of the hotel. There, they can not only enjoy the full range of fitness facilities but also breathtaking views of Shanghai while swimming in the indoor swimming pool.

FITNESS CENTER

The Fitness Center at The Grand Hyatt Shanghai is located on the 57th floor. It is equipped with new fitness equipment, including a variety of weight and strength training equipment, exercise bikes, and treadmills with independent TV monitors and headphones. Guests can enjoy a panoramic view of Shanghai through the 180-degree floor-to-ceiling glass windows while exercising. Yoga classes are also available for members, promoting a healthier lifestyle. The spacious indoor areas with floor-to-ceiling glass windows offer stunning views of the city. After a busy day, guests can escape the hustle and bustle of the city and find peace and tranquillity at the fitness centre.

SWIMMING POOL

The indoor swimming pool, with its temperature-controlled environment, offers a panoramic view of Shanghai. The circular pool's double-layer overflow design, curved ceiling, circular shape, and teak wood floor finish complement each other, creating a harmonious and unified atmosphere.

GRAND



Located in the heart of Pudong's financial and trade district, The Grand Hyatt Shanghai stands atop the renowned Jinmao Tower, just a stone's throw away from Puxi across the Huangpu River. With a panoramic view of the entire city, you can also take advantage of the hotel's superior location to visit Shanghai's famous tourist attractions.

ATTRACTIONS

- The Bund
- Yu Garden/Shanghai Old Street
- Jade Buddha Temple
- Shanghai Museum
- Xintiandi
- Nanjing Road Pedestrian Street
- Oriental Pearl Tower
- Tianzifang
- Shanghai Ocean Aquarium
- Jing'an Temple
- Shanghai Circus World
- Shanghai Disneyland

TRANSPORTATION

From	Distance	Time/By
Pudong International Airport	40 km	45 min by Car
Hongqiao International Airport & Railway Station	25 km	45 min by Car
Shanghai Railway Station	12 km	20 min by Car
Maglev Station	10 km	20 min by Car
Metro Line II Lujiazui Station	0.5 km	5 min Walk

GRAND

